

Control handwheels with scale lug

Aluminium black, anodized

SPECIFICATION

Types

- Type **A**: without handle
- Type **D**: with revolving handle

Bore codes

- Version **B**: without keyway
- Version **K**: with keyway
- Version **Z**: with collet

Coding

- Coding **S**: with standard scale 0...90, 100 graduations acc. scale scheme d/100 A RA 0-10 20...90/10 (only for bore code Z)

Aluminium
anodized, black

Hub cover
Plastic, light grey

Collet / Hexagon nut
Brass

Revolving cylindrical handles
Plastic, Technopolymer
black, matt



INFORMATION

Control handwheels GN 736.1 are used for setting operations with low torque. Coarse setting is made by means of the cylindrical handle (fingertip grip) followed by fine setting using the knurled rim of the knob.

The model fitted with collet offers an absolutely reliable mounting on the shaft and at the same time allows an easy setting of the adjustable scale ring wheel. The scale is wear resistant and easily legible since the engraved alu coloured numbers contrast with the black anodized surface. Besides the standard scale (Coding S) the control handwheels can be supplied with any type of graduation.

Full details of the available graduations, numbering sequence, number position and type of scale see under "How to order graduations" (see page 594).

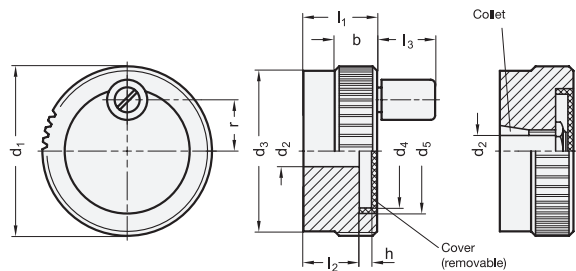

* Complete with type of the Control handwheel (A or D)

A without handle **D** with revolving handle

GN 736.1

Description	d1	d2 H8	d3	d4	d5	b -0.5	h	l1	l2	l3 ≈	r	Ø Handle	⚖
GN 736.1-52-B10-*	52	10	50	37	39.5	13	3.8	23	17	19	15.5	13	100
GN 736.1-52-K10-*	52	10	50	37	39.5	13	3.8	23	17	19	15.5	13	99
GN 736.1-52-Z10-*	52	10	50	37	39.5	13	3.8	23	17	19	15.5	13	111
GN 736.1-62-B10-*	62	10	60	47	49.5	13	3.8	23	17	21	20.5	14	142
GN 736.1-62-K10-*	62	10	60	47	49.5	13	3.8	23	17	21	20.5	14	141
GN 736.1-62-Z10-*	62	10	60	47	49.5	13	3.8	23	17	21	20.5	14	154

GN 736.1-S

Description	d1	d2 H8	d3	d4	d5	b -0.5	h	l1	l2	l3 ≈	r	Ø Handle	⚖
GN 736.1-52-Z10-*-S	52	10	50	37	39.5	13	3.8	23	17	19	15.5	13	110
GN 736.1-62-Z10-*-S	62	10	60	47	49.5	13	3.8	23	17	21	20.5	14	154

Weight type A

